

NOTES

- (a) ALL DIMENSIONS ARE IN METERS UNLESS OTHERWISE SPECIFIED.
- (b) ALL INTERNAL WALLS ARE 100 TH.
- (c) STATE OF CONSTRUCTION SHALL BE AS PER M.A.C.
- (d) OTHER SPECIFICATIONS WILL BE FOLLOWED AS PER M.A.C.

STATISTICS OF WORK

Sl. No.	Description	Quantity	Rate	Amount
1	1. Area of Plot	1131.81 Sqm	2.09	9337.14
2	2. Area of Building	1131.81 Sqm	1.80	2037.26
3	3. Area of Road	1131.81 Sqm	1.80	2037.26
4	4. Area of Terrace	1131.81 Sqm	1.80	2037.26
5	5. Area of Other	1131.81 Sqm	1.80	2037.26
6	6. Total Area	4527.24 Sqm	1.80	8149.03
7	7. Total Cost	4527.24 Sqm	1.80	8149.03

Part - A

Sl. No.	Description	Quantity	Rate	Amount
1	1. Area of Plot	1131.81 Sqm	2.09	9337.14
2	2. Area of Building	1131.81 Sqm	1.80	2037.26
3	3. Area of Road	1131.81 Sqm	1.80	2037.26
4	4. Area of Terrace	1131.81 Sqm	1.80	2037.26
5	5. Area of Other	1131.81 Sqm	1.80	2037.26
6	6. Total Area	4527.24 Sqm	1.80	8149.03
7	7. Total Cost	4527.24 Sqm	1.80	8149.03

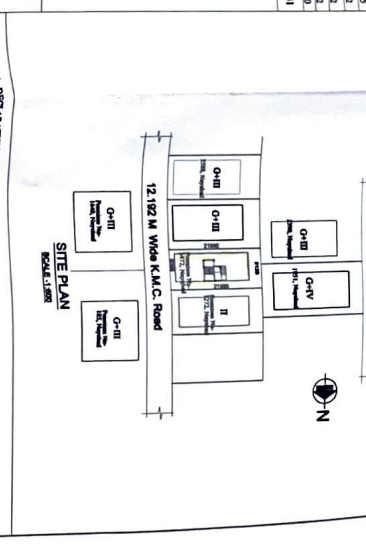

PROPOSED ADDITION & ALTERATION PLAN OF CIVIL STORED RESIDENTIAL BUILDING OF HEIGHT 13.600 M (PROPOSED 4TH FLOOR OVER SANCTIONED G+III STORED CARPET AREA 202.50 SQM) AS PER M.A.C. 1980 & AS PER M.A.C. 2009 WITH CURBULAR AREA OF 202.50 SQM AT PHASES SP/2, VAYADAKA WARD NO. 109, BORJOUR - XII, KOLKATA - 700 064 AT R.D. NO. 109/109A, WOLZI-NAYABAD, JLN-25, P.S. - PURBA MOHAVPUR, WED. B.P. NO. 2019/2020, DATED 19.02.2020.

SCALE
1:500
1:1000
1:6000
1:4000

CONSULTING CIVIL ARCHITECTURAL ENGINEERS
OFFICE: 1416, MALIND
Kolkata - 700 006, P.O. - BANGSALAH, 700 008

OWNER/DEVELOPER:
100 HEMET ROAD TAKES WITH FULL RESPONSIBILITY THAT
1) I HAVE INDOUGED L.S. & R.S. DURING CONSTRUCTION.
2) I HAVE FOLLOWED THE INSTRUCTIONS OF L.S. & R.S. DURING CONSTRUCTION.
3) I WILL ACCEPT FULL RESPONSIBILITY FOR THE STABILITY OF THE BUILDING ADJOINING STRUCTURES.
4) ANY SETTLEMENT DOCUMENTS ARE FOUND TO BE FALSE THE M.A.C. AUTHORITY MAY REMOVE THE SANCTION PLAN.
5) THE CONSTRUCTION OF WATER RESERVOIR AND SEPTIC TANK HAVE BEEN UNDERTAKEN UNDER THE GUIDANCE OF L.S. & R.S. BEFORE STARTING OF BUILDING FOUNDATION WORK.
6) THE PLOT OF LAND IS IDENTIFIED BY ME AT THE TIME OF DEPARTMENTAL INSPECTION.

REGISTERED ARCHITECT:
RUPAK KUMAR BANERJEE
RUPAK KUMAR BANERJEE
CIVIL ENGINEER
OFFICE: 1416, MALIND
Kolkata - 700 006, P.O. - BANGSALAH, 700 008

REGISTERED CIVIL ENGINEER:
Name of the Technical Engineer
Sri Rajat Kumar Banerjee
OFFICE: 1416, MALIND
Kolkata - 700 006, P.O. - BANGSALAH, 700 008

REGISTERED CIVIL ENGINEER:
Name of the Technical Engineer
Sri Rajat Kumar Banerjee
OFFICE: 1416, MALIND
Kolkata - 700 006, P.O. - BANGSALAH, 700 008

PARTY'S COPY

Before starting any Construction the site must conform with the plans sanctioned and all the conditions as proposed in the plan should be fulfilled.

The validity of the written permission to execute the work is subject to the above conditions.

A suitable pump has to be provided i.e. pumping unfiltered water for the distribution to the flushing cisterns and urinals in the building incase unfiltered water from street main is not available.

Non Commencement of Erection/
Re-Erection within Five year will
Require Fresh Application for Sanction

PC-2023120519



RESIDENTIAL BUILDING

Necessary steps should be taken for the safety of the lives of the adjoining public and private properties during construction.

All Building Materials to necessary & construction should conform's to standered specified in the National Building Code of India.

The building materials that will be stacked on Road/Passage or Foot-path beyond 3-months or after construction of G. Floor, whichever is earlier may be seized forthwith by the K.M.C. at the cost and risk of the owner.

No rain water pipe should be fixed or discharged on Road or Footpath. Drainage plan should be submitted at the Borough Executive Engineer's Office and the sanction obtained before proceeding with the drainage work.

Design of all Structural Members including that of the foundation should conform to Standards specified in the National Building Code of India

THE SANCTION IS VALIED
UP TO...19.01.2029

Plan for Water Supply arrangement including SEMILI G. & O. H. reservoirs should be submitted at the Office of the Ex-Engineer Water Supply and the sanction obtained before proceeding with the work of Water Supply any deviation may lead to disconnection/demolition.

CONSTRUCTION SITE SHALL BE MAINTAINED TO PREVENT MOSQUITO BREEDING AS REQUIRED U/S 496 (1) & (2) OF CMC ACT 1980. IN SUCH MANNER SO THAT ALL WATER COLLECTION & PARTICULARLY LIFT WELLS, VATS, BASEMENT CURING SITES, OPEN RECEPTACLES ETC. MUST BE EMPITED COMPLETELY TWICE A WEEK.

DEVIATION WOULD MEAN DEMOLITION

